

The Liny

Installation Sheet V00



Architectural Collection

kendila

Product Features

Please read this manual carefully before installation and use. Please keep it for reference.

Warm Tips

- This product is suitable for indoor and outdoor use, and should be kept away from open fire or high-temperature objects. Please install and use it by professional electrical personnel.
- Before installing and using the product, please confirm that the product is not damaged during transportation for timely replacement or return, so as to ensure the legitimate rights and interests of consumers.
- Non professionals are not allowed to disassemble and repair the product. If maintenance is required, please contact our sales person. Our company will not replace or guarantee the product disassembled and repaired without permission.
- Before cleaning the product, please turn off the power and do the cleaning with dry cloth. Please do not clean with chemical or corrosive solvents.

Installation Note:

- Please install the luminaries by professional electrical personnel to avoid accidents or damage to the product.
- Cut off the power supply before wiring, and a power supply in 24VDC complying with class2 must be used. Please refer to our compatible drivers in the product page.
- Please handle with care during installation to ensure the best performance of the product.
- If it is not installed following the relevant requirements and regulations in the manual, the manufacturer shall not be responsible for the loss and damage caused.

Fixing Accessories

Clip & Screw

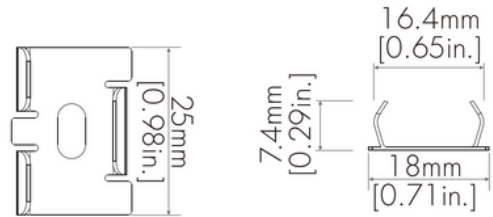
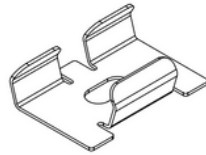

60 Rotatable Bracket

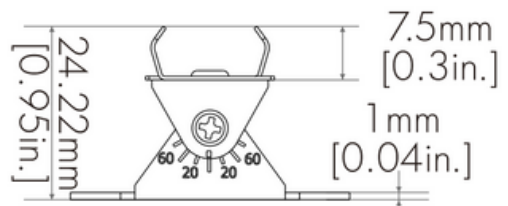
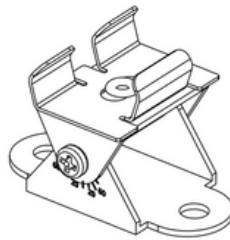

90 Rotatable Bracket

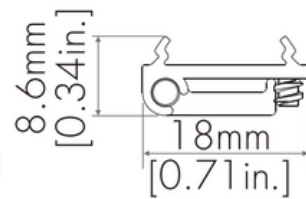
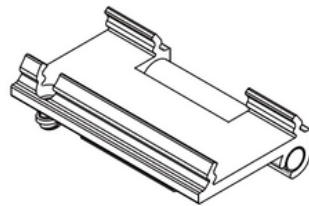

120 Rotatable Bracket

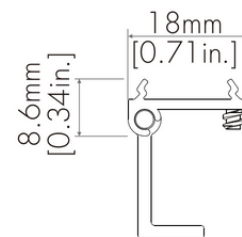
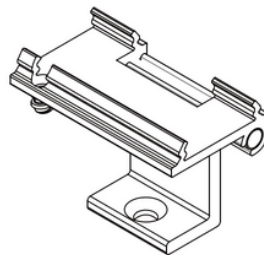

Tools & Product Preparation

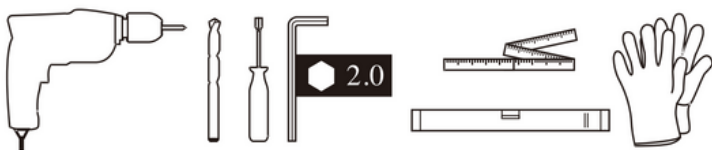

Notice:

Take out the product from packaging with care to ensure that the product is intact and prevent falling.

Installation Steps

Clip & Screw

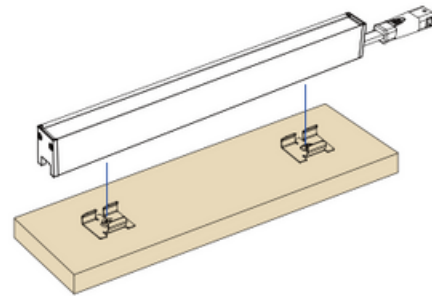
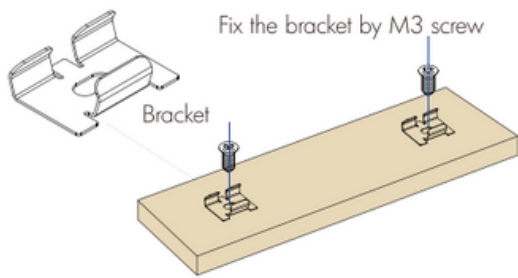

- 2 pcs are recommended for each 1M (3.28ft) long fixture

- Fix the product by clipping it into the bracket

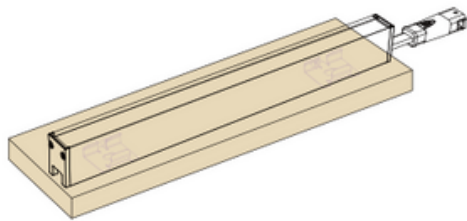

- Adjust, verify and complete

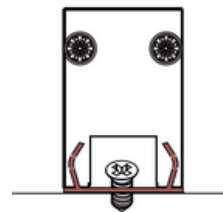

- Sectional view of the product after installation

60 Degree Bracket

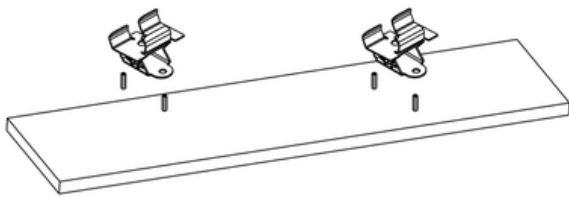

- Locate the area where the fixture needs to be installed
- Drill holes and insert the expanded rubber particle.

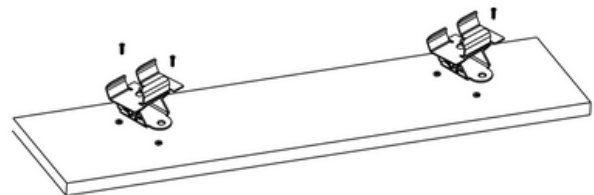

- Fix the bracket into the rubber particle by screw
- 2 pcs are recommended for each 1M (3.28ft) long fixture

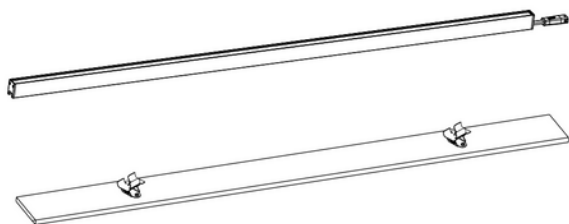

- Fix the luminaire by clipping it into the bracket
- Adjust to the desired angle, lock with the screw

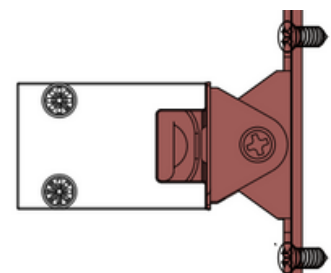

- Sectional view of the product after installation

Installation Steps

90 Degree Bracket

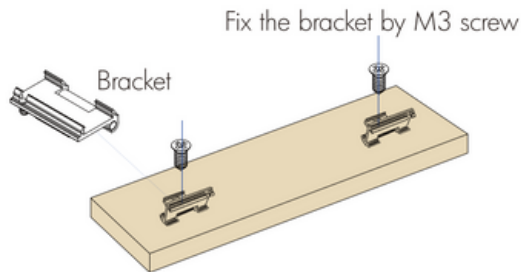

- 2 pcs are recommended for each 1M (3.28ft) long fixture

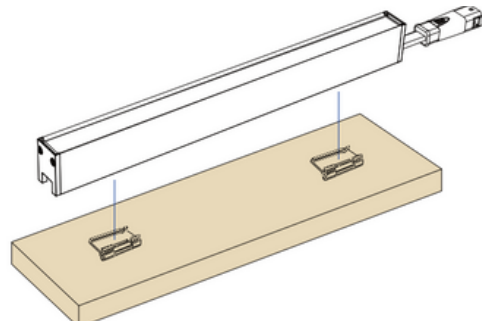

- Fix the product by clipping it into the bracket

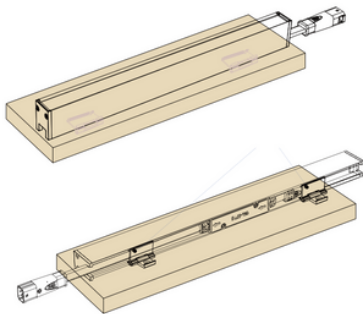

- Adjust, lock the fixation screw and complete

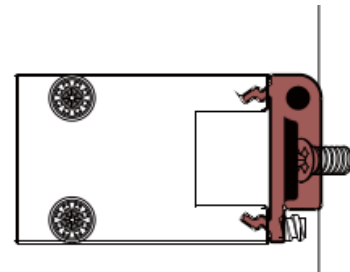

- Sectional view of the product after installation

180 Degree Bracket

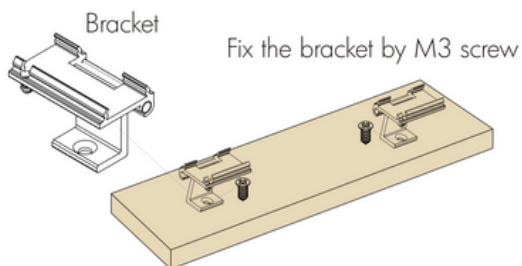

- 2 pcs are recommended for each 1M (3.28ft) long fixture

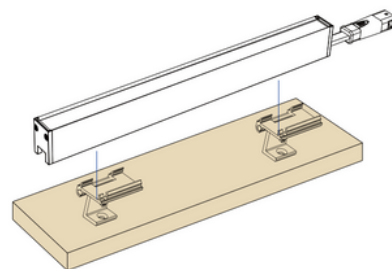

- Fix the product by clipping it into the bracket

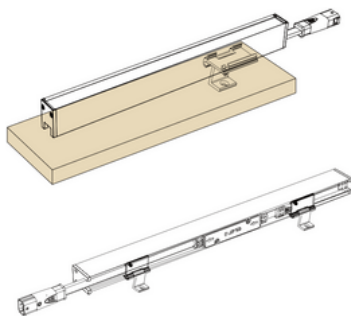

- Adjust, lock the fixation screw and complete

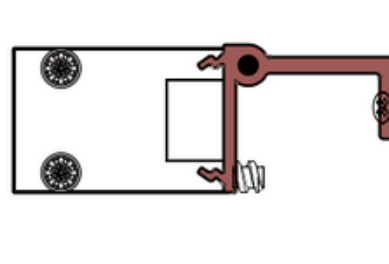

- Sectional view of the product after installation

Connection Diagram

• Non dimmable Connection

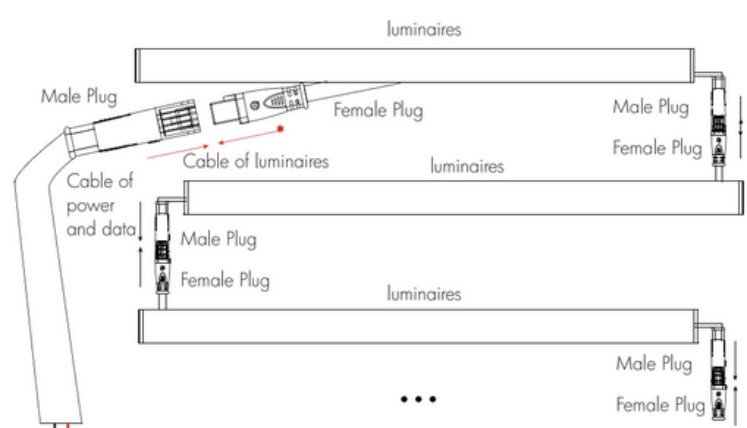
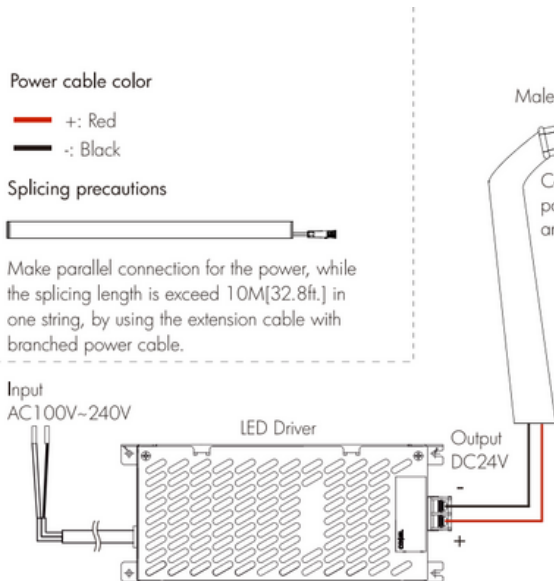

Notice: Use the female plug with end cap, to seal the male terminal of the last luminaires.

• Dimmable Connection

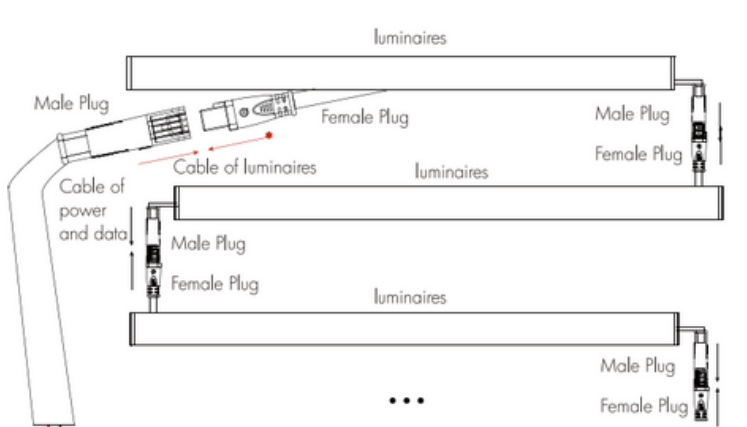
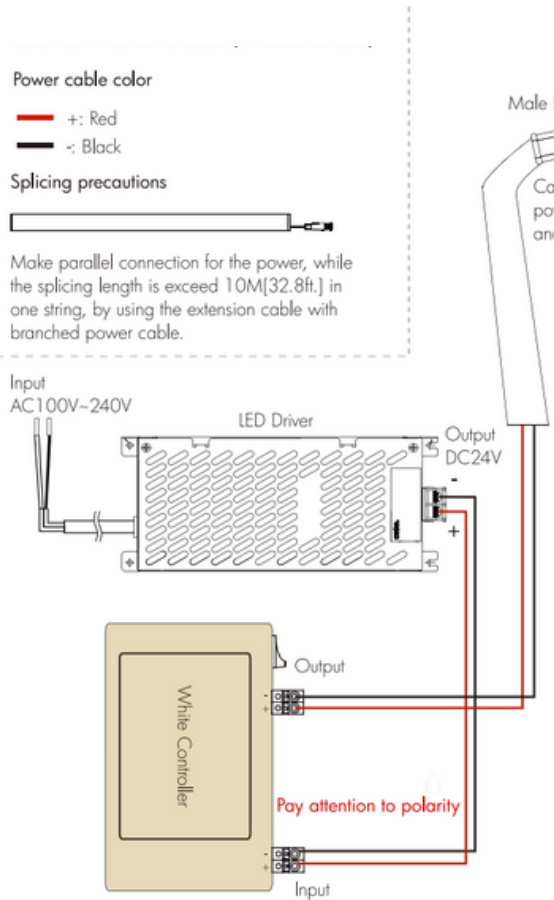

Notice: Use the female plug with end cap, to seal the male terminal of the last luminaires.

Note:

- To ensure the correct installation, maintenance, and inspection of the product, please entrust electrical and electrician professionals to be responsible.
- Please use it according to the rated voltage marked on the package or product. Do not use it in a too higher or too lower voltage, otherwise, it is easy to cause product failure.
- Before installation, you must first cut off the power supply.
- Do not look directly at the product for a long time when it is illuminating. The powerful light generated by the product may hurt your eyes.
- Do not install the product near the stove, gas, and exhaust funnel to avoid damage.
- Non-professional personnel shall not carry out disassembly and maintenance.

Pay attention to the following points when installing in all methods

- Check whether all connectors are connected well and firmly.
- Check that all power cords are connected correctly.
- All the illustrations in the user instruction are diagrams only.

kendila

Installation Sheet V00 - Architectural - The Liny



Sales@kendila.com



www.kendila.com



+1 514 999 8098