

kendila

NIXY

Linear Series

Installation. V01

Architectural Collection

www.kendila.com



BEFORE YOU BEGIN

- This product is suitable for indoor use only, and should be kept away from open fire or high temperature objects. Please install and use it by professionals.
- Before installing and using the product, please confirm that the product is not damaged during transportation for timely replacement or return, so as to ensure the legitimate rights and interests of consumers.
- Non professionals are not allowed to disassemble and repair the product. If maintenance is required, please contact our sales person. Our company will not replace or guarantee the product disassembled and repaired without permission.
- Before cleaning the product, please turn off the power and do the cleaning with dry cloth. Please do not clean with chemical or corrosive solvents.

INSTALLATION NOTES

- Installation must be done by qualified electrical personnel to avoid damage or accidents.
- Use only compatible drivers listed on the product page.
- The manufacturer is not liable for damage caused by improper installation or failure to follow the
- Compatible with standard TRIAC dimmers for simple ON/OFF control
- Smooth, flicker-free dimming performance
- Wide and effective dimming range
- Synchronized brightness adjustment between Nixy and the TRIAC dimmer – full brightness at max dimmer level, and minimal brightness at lowest dimmer level

ACCESSORIES

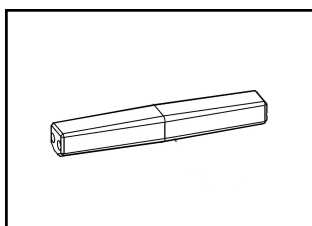

EXTENSION CONNECTOR

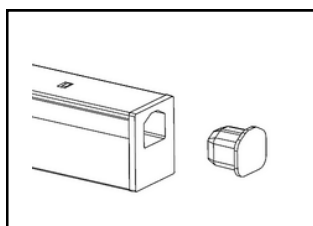

END CAP

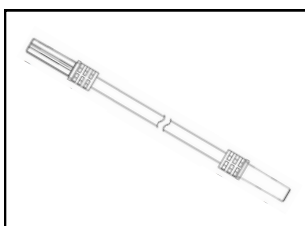

JUMPER CABLE

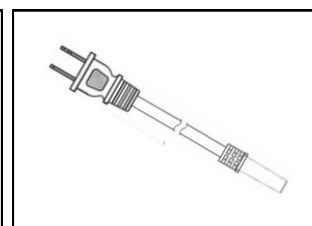

POWER CABLE

CABLE CONFIGURATIONS

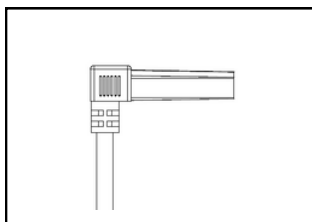

90° CORNER PLUG

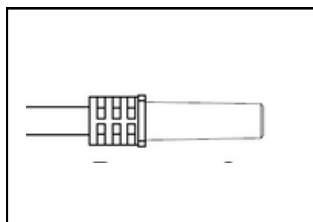

STRAIGHT PLUG



INSTALLATION STEPS

Magnet

Magnet on backside is embedded inside the PC housing.

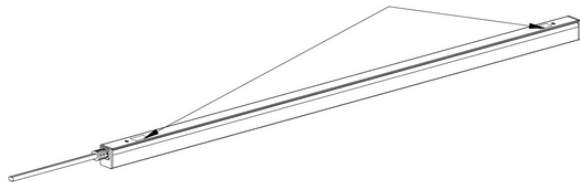

Directly stick to the metal mounting surface.

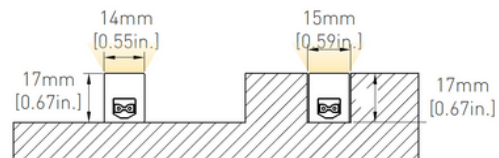

Surface Mounting

Flush Mounting
Groove size:
W15*H17mm
[W0.59*H0.67in.]

Magnet & Metal Sheet

Fix the metal sheet by screw according to the position of the magnet firstly, and then stick the product to the metal sheet

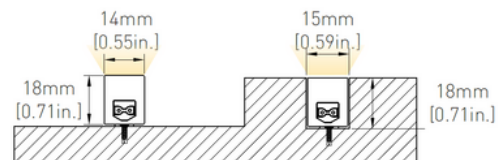
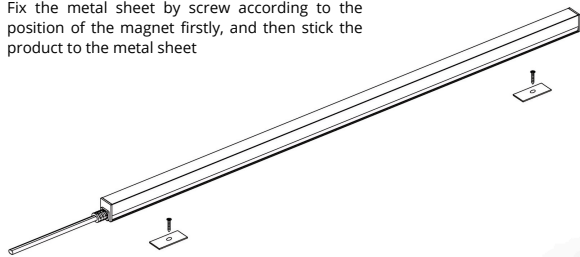

Surface Mounting

Flush Mounting
Groove size:
W15*H18mm
[W0.59*H0.71in.]

Adhesive Tape

Peel off the adhesive tape on backside, and then stick to the mounting surface.

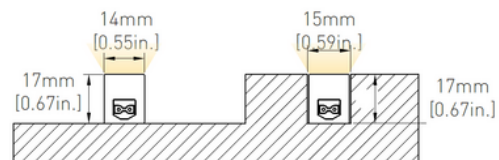
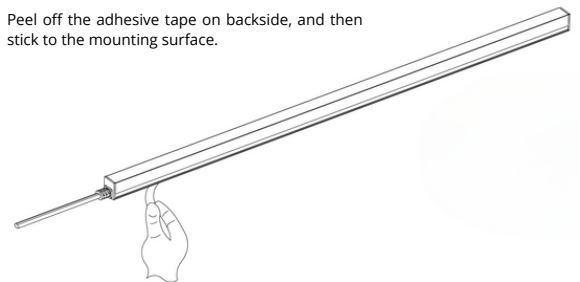

Surface Mounting

Flush Mounting
Groove size:
W15*H17mm
[W0.59*H0.67in.]

Clip & Screw

Fix the bracket to the mounting surface by screw firstly, and then clip the product into the bracket

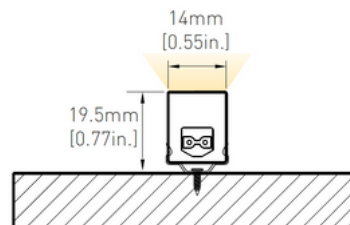
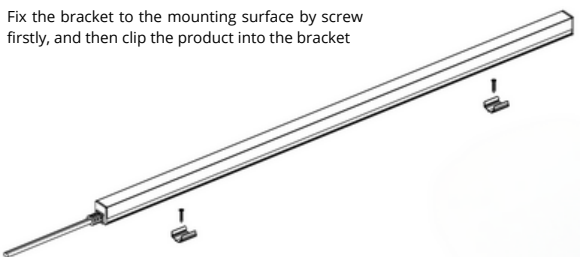

Surface Mounting



CONNECTION

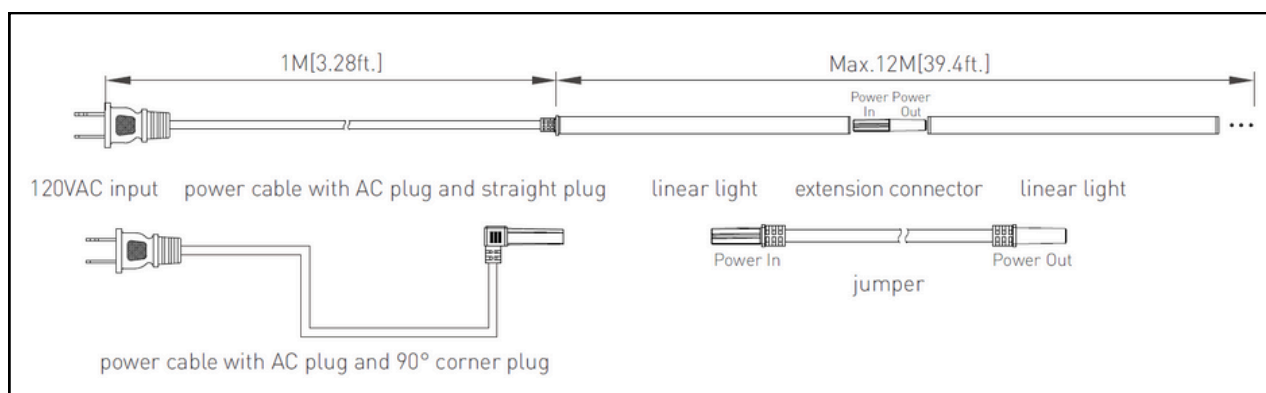

1

protective film

Peel off the protective film on the light emitting surface

2

Extension Connector

Splicing multiple products by extension connector or jumper cable

3

Insert the power cable into the product

4

Seal the terminal socket by inserting the end cap, which is required for the product at the tail in the same string

TERMS & NOTICE

Kendila reserves the right to change the specification, material and colors at any time without notice. Standard warranty terms and conditions apply.

All dimensions and values on specification sheet are nominal.

- K-ISV01-ARC-NIXY-EN : March 2025

COMPLIANCE & WARRANTY

