

kendila

Graze MEDUSA

Linear Flex Series

Installation. V00

Architectural Collection

www.kendila.com



BEFORE YOU BEGIN

- This product is suitable for indoor and outdoor use, and should be kept away from open fire or high temperature objects. Please install and use it by professionals.
- Before installing and using the product, please confirm that the product is not damaged during transportation for timely replacement or return, so as to ensure the legitimate rights and interests of consumers.
- Non professionals are not allowed to disassemble and repair the product. If maintenance is required, please contact our sales person. Our company will not replace or guarantee the product disassembled and repaired without permission.
- Before cleaning the product, please turn off the power and do the cleaning with dry cloth. Please do not clean with chemical or corrosive solvents.

INSTALLATION NOTES

- Please install the luminaries by professional electrical personnel to avoid accidents or damage to the product.
- Cut off the power supply before wiring, and a power supply in 24VDC complying with class2 must be used.
- Please refer to our compatible drivers in the product page. Please handle with care during installation to ensure the best performance of the product.
- If it is not installed following the relevant requirements and regulations in the manual, the manufacturer shall not be responsible for the loss and damage caused.

FIXATION ACCESSORIES

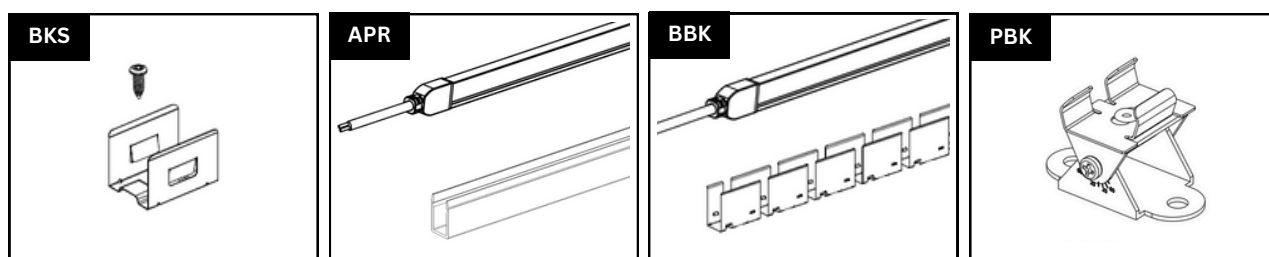

CABLE FEED

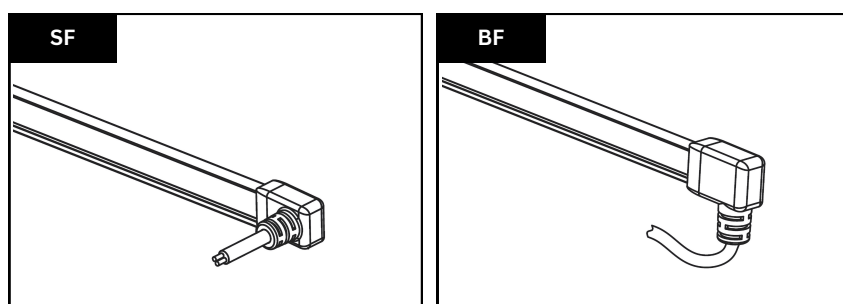



CUTTING & ASSEMBLY

By default, the fixture is supplied in custom-cut lengths as per project specifications. For on-site cutting and assembly, optional front and end caps are available to enable full section utilization. Note: field modifications will reduce the ingress protection rating from IP67 to IP65

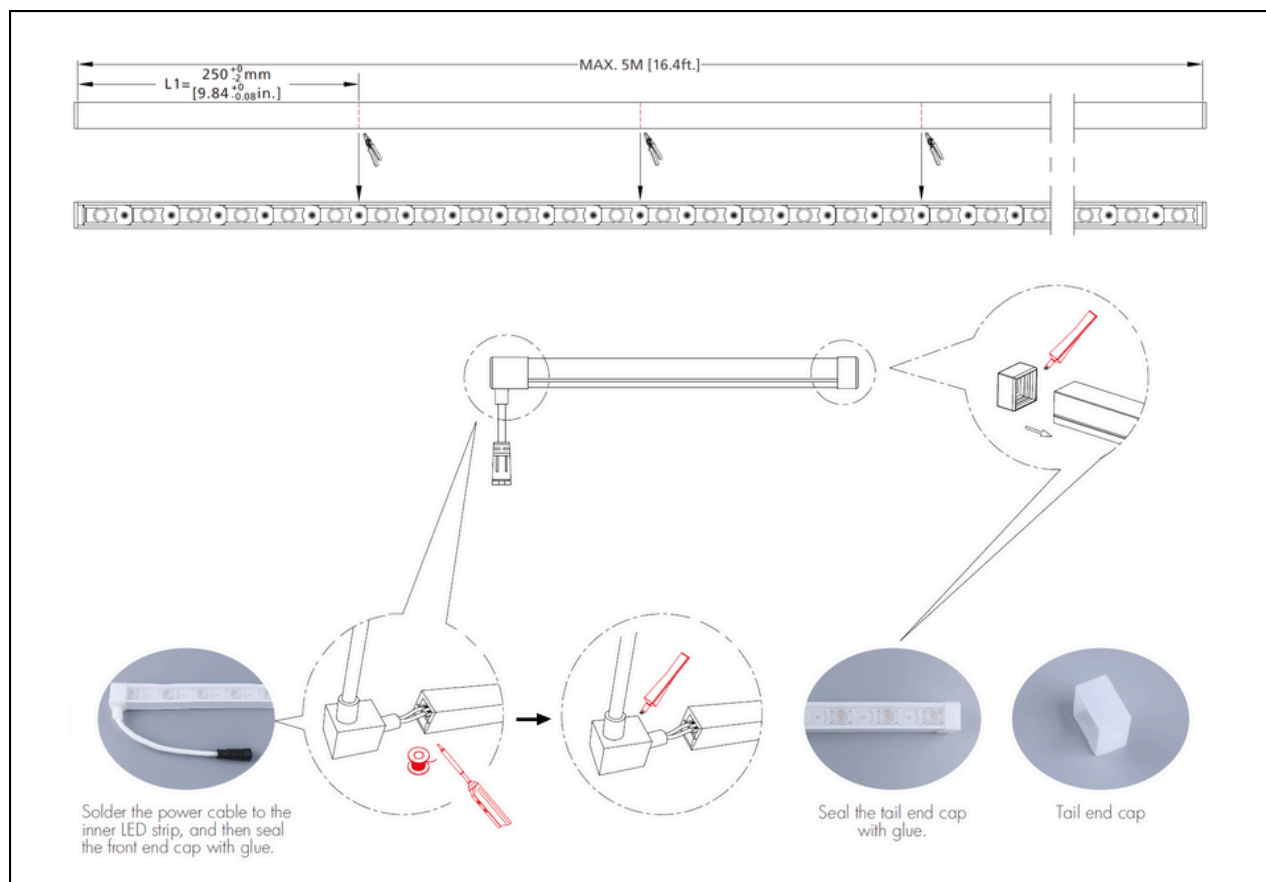

CONNECTION

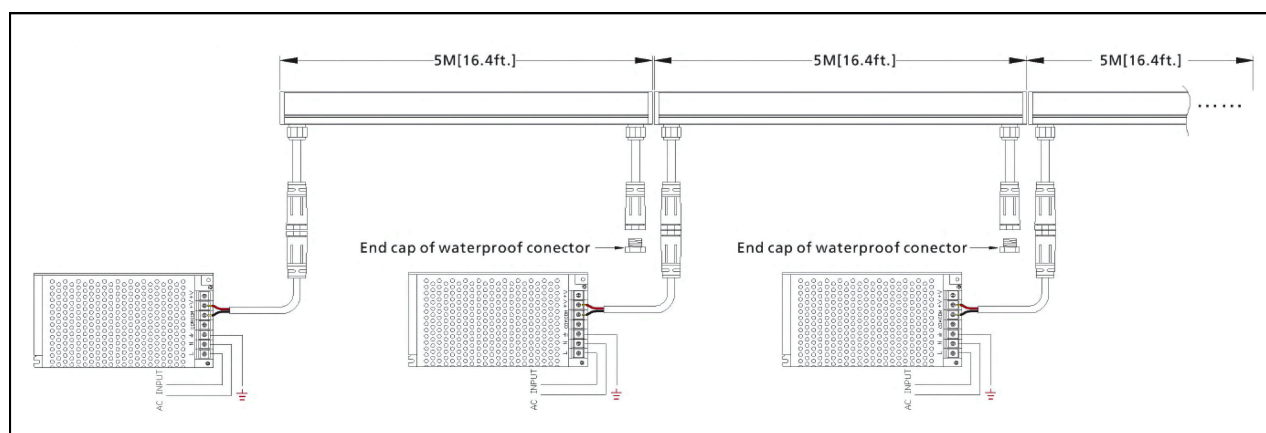



INSTALLATION STEPS

Clip & Screw

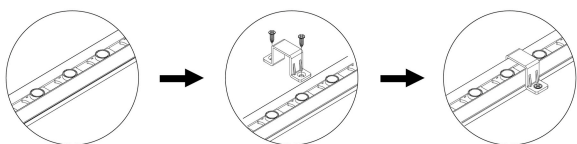

Bracket & Screw

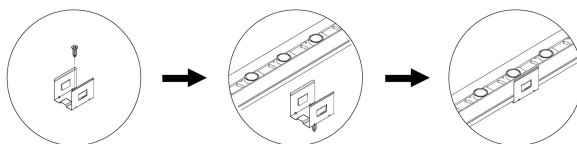

Aluminum Profile

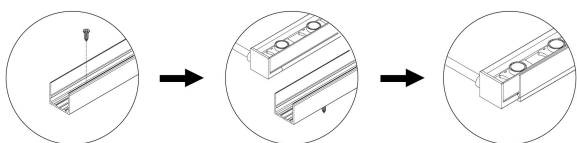

Bendable Bracket

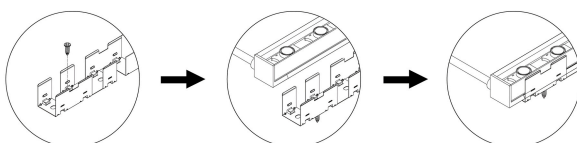

Pivoting Bracket



On ground

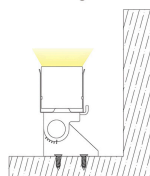

On wall

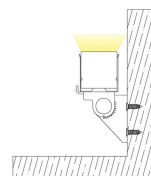

On ceiling

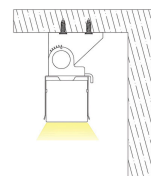

Considering the elasticity of the product itself, there are some restrictions when using the rotatable bracket for side-bend installation.

- For bending diameter >1000mm[39.4in.], all arcs and circles corresponding to any radian can be made.
- For bending diameter 500~1000mm[19.7~39.4in.], only arcs corresponding to radian below 120° can be made.
- For bending diameter <500mm[39.4in.], no arc corresponding to any radian can be made.

TERMS & NOTICE

Kendila reserves the right to change the specification, material and colors at any time without notice. Standard warranty terms and conditions apply.

All dimensions and values on specification sheet are nominal.

- K-ISV00-ARC-MEDUSA-GRAZE-EN : April 2025

COMPLIANCE & WARRANTY

